

Public Notice: Disposition of City Land and Intent to Provide Assistance

Published: August 15, 2024

NOTICE is hereby given pursuant to Section 26 of the *Community Charter* that the City of Burnaby (the “**City**”) intends to grant a statutory right of way over City-owned land (the “**SRW**”) as follows:

Lands: Portion of City-owned property, as shown on Plan EPP138107 located at 6889 Royal Oak Avenue, Burnaby, British Columbia and legally described as PID: 031-859-348, Lot 1 District Lot 98 Group 1 New Westminster District Plan EPP108565

EXPLANATORY PLAN OF STATUTORY RIGHT OF WAY OVER PART OF LOT 1, DL 98, GROUP 1, NWD, PLAN EPP108565.

PLAN EPP138107

Pursuant to Section 99(1)(e), Land Title Act

BCGS 92G.026

For Hydro Utility Purposes

Scale 1 : 500 

The intended plot size of this plan is 432mm in width by 280mm in height (B Size) when plotted at a scale of 1:500

All distances are in metres and decimals thereof.

Bearings and distances were derived from Plan EPP108565

Integrated Survey Area No. 25,
Burnaby, NAD'83 (CSRS) 4.0.0.BC.1.MVRD

Legend

m² denotes square metres

The City of Burnaby
Engineering Dept. Survey Section
4945 Canada Way, Burnaby, B.C.
V5G 1M2
Phone : (604) 294-7463
Fax : (604) 294-7425

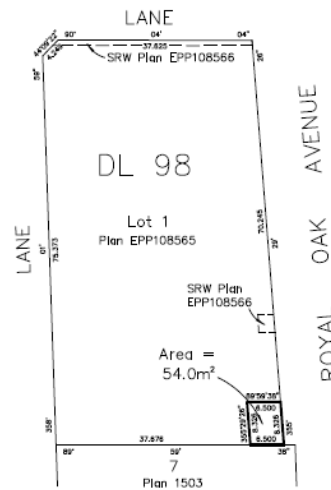

This plan lies within the Metro Vancouver Regional District

This plan is based on the following
Land Title and Survey Authority of BC
records: Plan EPP108565.

G. N. Holme, BCLS #736
on the 22nd day of May, 2024

Grantee: British Columbia Hydro and Power Authority

Consideration: \$1.00

NOTICE is hereby given pursuant to Section 24 of the *Community Charter* that the City intends to provide assistance to the Grantee by granting the SRW for less than market value. The estimated market value of the SRW is \$11,600.

Legal Department

City of Burnaby | Suite 205 - 4946 Canada Way, Burnaby, BC V5G 4H7

